

CONTACT PRECAUTIONS

Bed #

**Families
and
visitors:**



**Please report
to staff before
entering**

**Clean hands
before entering and
when leaving room**

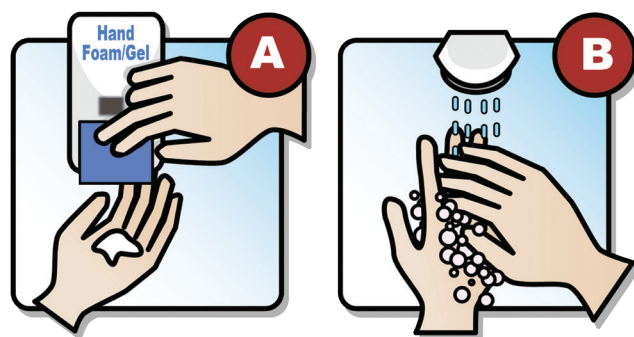

Clean hands with
A) hand foam/gel or **B)** soap and water

Staff:

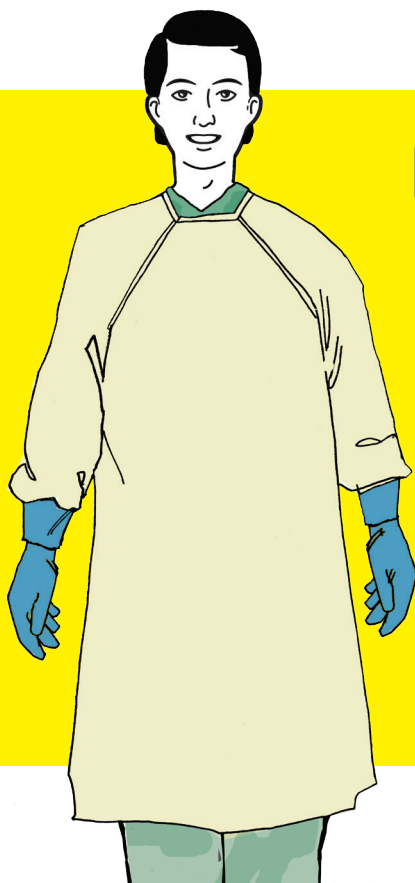

Required:

- Gown & Gloves

Point-of-Care Risk Assessment

When there is a risk
of splash or spray,
wear face and eye
protection.



**KEEP
SIGN POSTED
UNTIL ROOM
CLEANED**
HOUSEKEEPER will
remove sign after
"Discharge"
cleaning

For more information, refer to IPAC documents on the portal *OurNH*.

CONTACT PLUS PRECAUTIONS

Bed #

**Families
and
visitors:**



**Please report
to staff before
entering**

**Clean hands
before entering and
when leaving room**

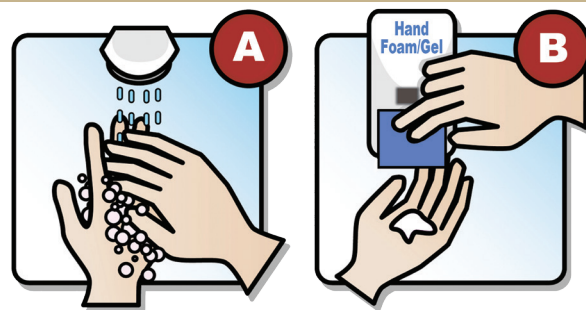

- A** Wash hands with soap & water (preferred)
- B** Clean hands with alcohol hand rub and wash with soap and water at first opportunity

Staff:

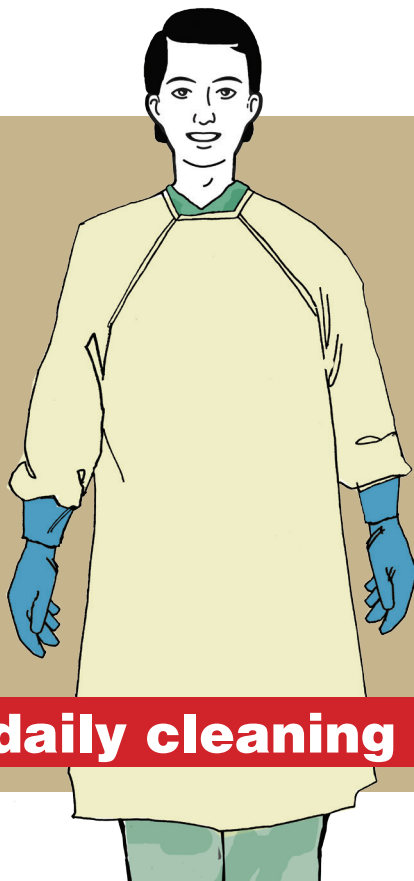

**KEEP
SIGN POSTED
UNTIL ROOM
CLEANED**
HOUSEKEEPER will
remove sign after
"Discharge"
cleaning

Required:

- Gown & Gloves

Point-of-Care Risk Assessment

When there is a risk
of splash or spray,
wear face and eye
protection.



For more information, refer to IPAC documents on the portal *OurNH*.

Twice daily cleaning of high-touch surfaces

DROPLET PRECAUTIONS

Bed #

Families and visitors:



Please report to staff before entering

Clean hands before entering and when leaving room

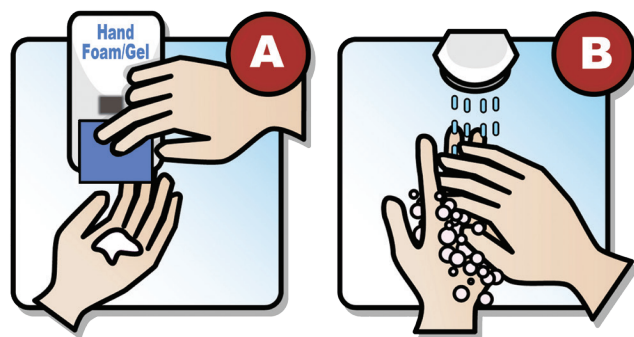

Clean hands with
A) hand foam/gel or **B)** soap and water

Staff:

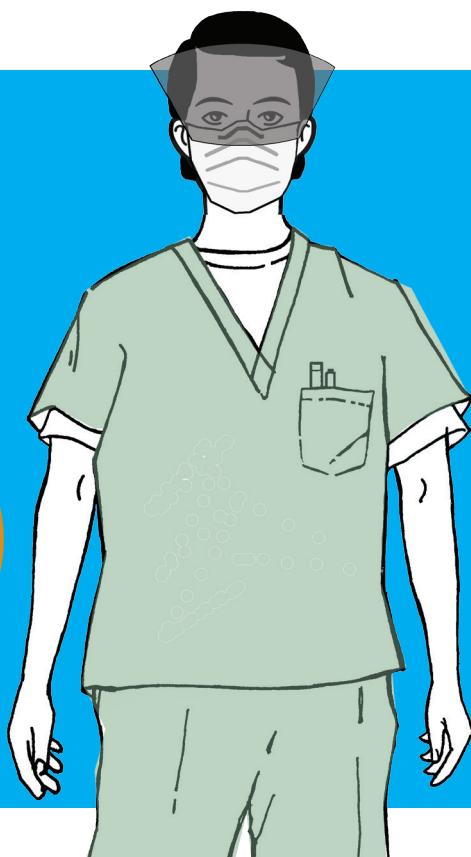

**KEEP
SIGN POSTED
UNTIL ROOM
CLEANED**
HOUSEKEEPER will
remove sign after
“Discharge”
cleaning

Required:

- Point of Care Risk Assessment**
- Procedure mask with eye protection**
When within 2 metres of patient
- Keep 2 metres between patients**

For more information, refer to IPAC documents on the portal *OurNH*.

DROPLET & CONTACT PRECAUTIONS

Bed #

Families and visitors:



Please report to staff before entering

Clean hands before entering and when leaving room

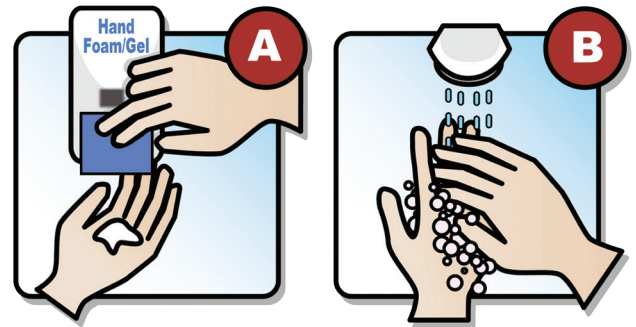

Clean hands with
A) hand foam/gel or **B)** soap and water

Staff:

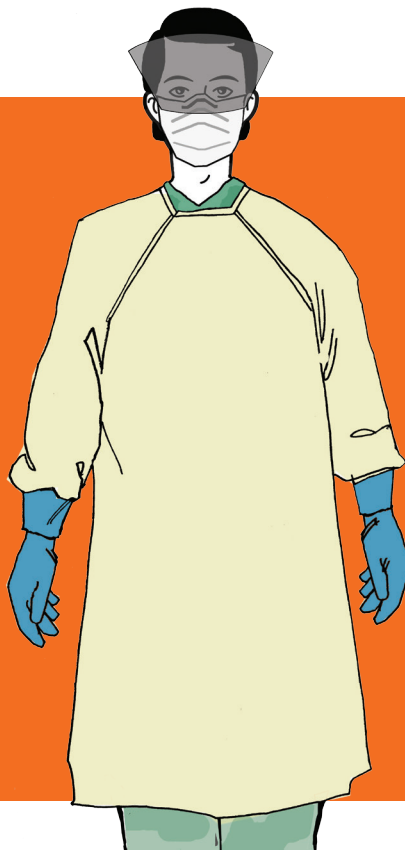

**KEEP
SIGN POSTED
UNTIL ROOM
CLEANED**
HOUSEKEEPER will
remove sign after
"Discharge"
cleaning

Required:

- **Point of Care Risk Assessment**
- **Gown & Gloves**
- **Procedure mask with eye protection**
When within 2 metres of patient
- **Keep 2 metres between patients**

For more information, refer to IPAC documents on the portal *OurNH*.

AIRBORNE PRECAUTIONS

**Private Room
Negative Pressure**

Keep door closed

**Families
and
visitors:**



**Please report
to staff before
entering**

**Clean hands
before entering and
when leaving room**

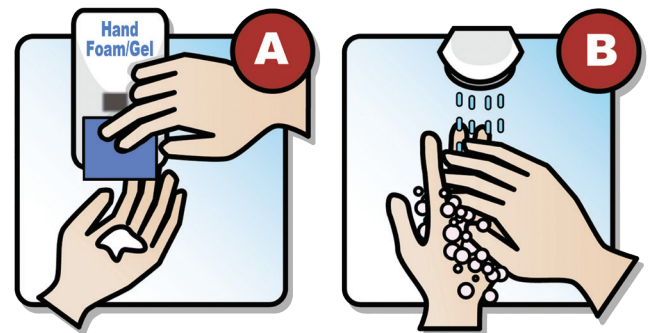

Clean hands with
A) hand foam/gel or **B)** soap and water

Staff:

**KEEP
SIGN POSTED
UNTIL ROOM
CLEANED**
HOUSEKEEPER will
remove sign after
"Discharge"
cleaning



Required:

- Point of Care Risk Assessment**
- N95 Respirator**



Notify Infection Prevention & Control - Before Discontinuing Airborne Precautions

For more information, refer to IPAC documents
on the portal *OurNH*.

AIRBORNE & CONTACT PRECAUTIONS

**Private Room
Negative Pressure**

Keep door closed

**Families
and
visitors:**



**Please report
to staff before
entering**

**Clean hands
before entering and
when leaving room**

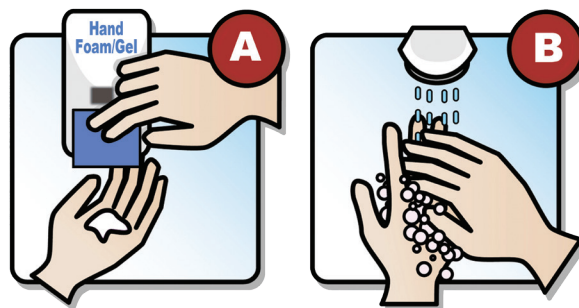

Clean hands with
A) Hand foam/gel or B) soap and water

Staff:

**KEEP
SIGN POSTED
UNTIL ROOM
CLEANED**
HOUSEKEEPER will
remove sign after
"Discharge"
cleaning

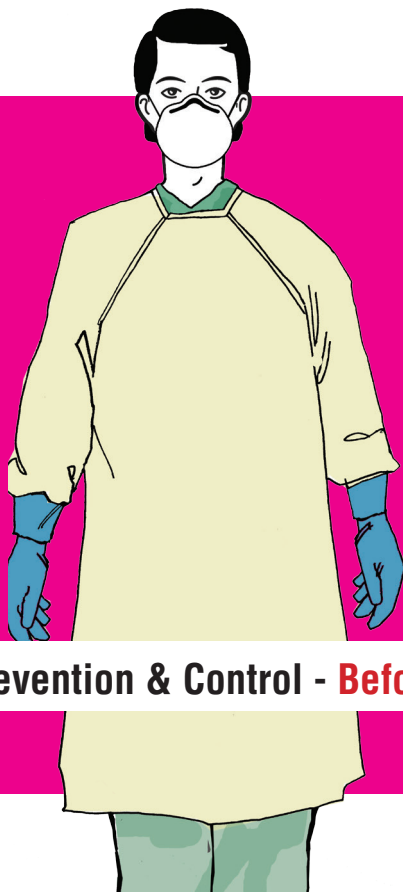

Required:

- Point of Care Risk Assessment**
- Gown and gloves**
- N95 respirator**



Notify Infection Prevention & Control - Before Discontinuing Airborne Precautions

For more information, refer to IPAC documents on the portal *OurNH*.

Point of Care Risk Assessment

Risk	Protection
• Contact with patient or environment expected	• Hand hygiene
• Splash or spray of blood or body fluids/secretions anticipated	• Mask and eye protection • Put on gown if soiling of clothing is likely
• Contact with mucous membranes • Non-intact skin, blood, body fluids, secretions, excretions or soiled or likely soiled item/surface anticipated	• Perform hand hygiene, then don gloves • Perform hand hygiene after PPE removal and before leaving patient environment

	Contact	Contact Plus	Droplet	Droplet + Contact	Airborne	Airborne+ Contact
Organism-based precautions (examples only; not complete list)	CPO, MRSA, VRE, lice, scabies	<i>C. difficile</i>	<i>N. meningitidis</i> , mumps, pertussis	Influenza, invasive group A <i>Streptococcus</i>	Tuberculosis (TB), measles	Varicella (chickenpox, disseminated herpes zoster)
Syndromic precautions	Draining wound, diarrhea, infestation	Diarrhea and/or vomiting	Stiff neck + fever + headache	Malaise + acute cough + fever, toxic shock	Fever + weight loss + cough + high risk for TB	Disseminated rash + fever
Private room	Preferred. For suspect & confirmed CPO: yes	Preferred	Preferred. If in multi-bed room, draw curtain.	Preferred. If in multi-bed room, draw curtain.	Yes	Yes
Negative pressure room	No	No	No	No	Yes	Yes
Staff PPE	Gown + gloves	Gown + gloves	Procedure mask and eye protection	Procedure mask + eye protection + gown + gloves	N95 respirator	N95 respirator + gown + gloves
Visitor PPE	Gown + gloves if direct care	Gown + gloves	Procedure mask and eye protection	Procedure mask + eye protection (+gown +gloves if direct care)	Offer N95 respirator to visitor	N95 respirator (+gown +gloves if direct care)
Parents of pediatric patients	Clean hands before entering and on leaving room. Do not go into common areas such as patient kitchens, playrooms, school rooms, patient lounges.					
Patient wears a procedure mask during transport	No	No	Yes	Yes	Yes	Yes