

# CONTACT PRECAUTIONS

Bed #

**Families  
and  
visitors:**



**Please report  
to staff before  
entering**

**Clean hands  
before entering and  
when leaving room**

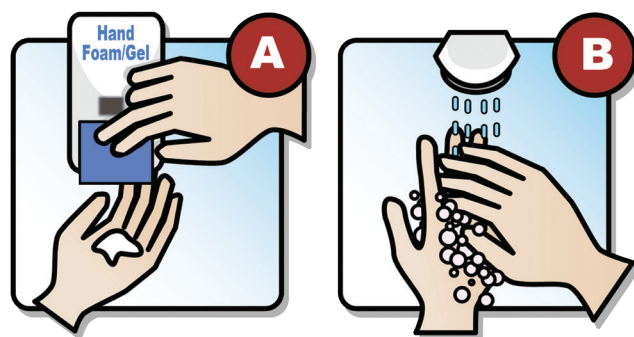

Clean hands with  
**A)** hand foam/gel or **B)** soap and water

**Staff:**

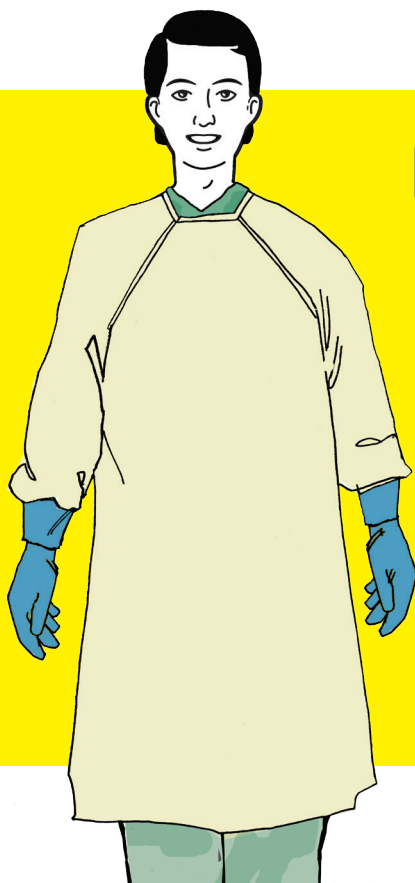

**Required:**

**- Gown & Gloves**

**Point-of-Care Risk Assessment**

When there is a risk  
of splash or spray,  
wear face and eye  
protection.



**KEEP  
SIGN POSTED  
UNTIL ROOM  
CLEANED**  
HOUSEKEEPER will  
remove sign after  
"Discharge"  
cleaning

# CONTACT PLUS PRECAUTIONS

Bed #

**Families  
and  
visitors:**



**Please report  
to staff before  
entering**

**Clean hands  
before entering and  
when leaving room**

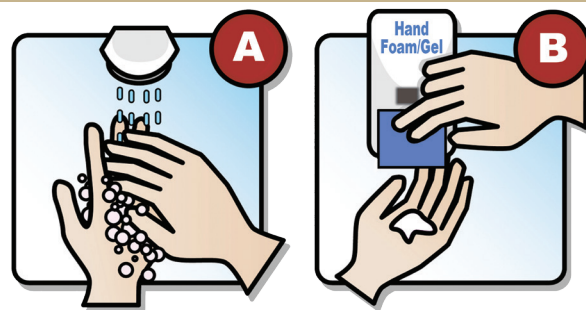

- A** Wash hands with soap & water (preferred)
- B** Clean hands with alcohol hand rub and wash with soap and water at first opportunity

**Staff:**

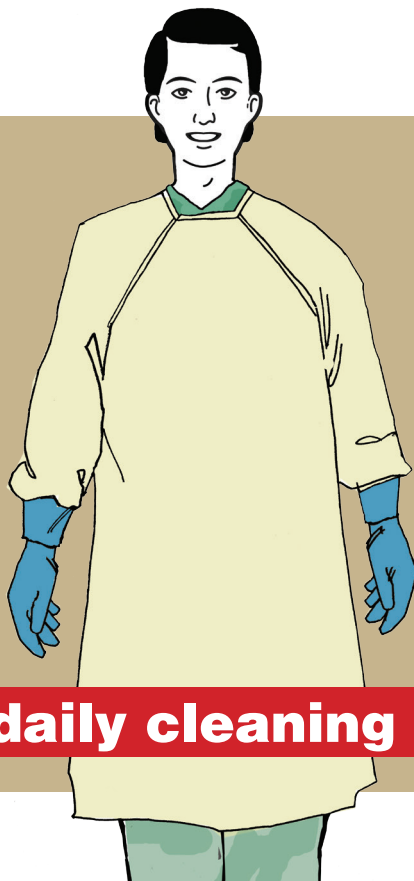

**KEEP  
SIGN POSTED  
UNTIL ROOM  
CLEANED**  
HOUSEKEEPER will  
remove sign after  
"Discharge"  
cleaning

**Required:**

**- Gown & Gloves**

**Point-of-Care Risk Assessment**

When there is a risk  
of splash or spray,  
wear face and eye  
protection.



**Twice daily cleaning of high-touch surfaces**

# DROPLET PRECAUTIONS

**Bed #**

**Families  
and  
visitors:**



**Please report  
to staff before  
entering**

**Clean hands  
before entering and  
when leaving room**

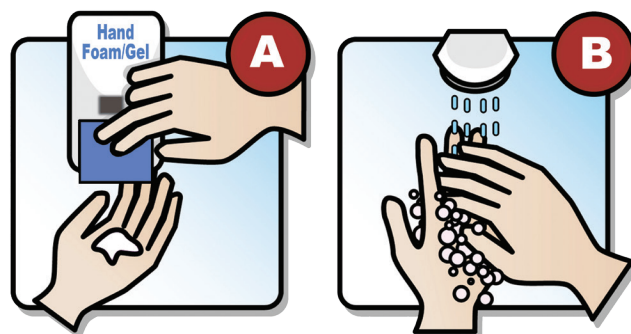

Clean hands with  
**A)** hand foam/gel or **B)** soap and water

**Staff:**



**KEEP  
SIGN POSTED  
UNTIL ROOM  
CLEANED**  
HOUSEKEEPER will  
remove sign after  
"Discharge"  
cleaning

**Required:**

- Point of Care Risk Assessment**
- Procedure mask with eye protection**  
When within 2 metres of patient
- Keep 2 metres between patients**

# DROPLET & CONTACT PRECAUTIONS

**Bed #**

**Families and visitors:**



**Please report to staff before entering**

**Clean hands before entering and when leaving room**

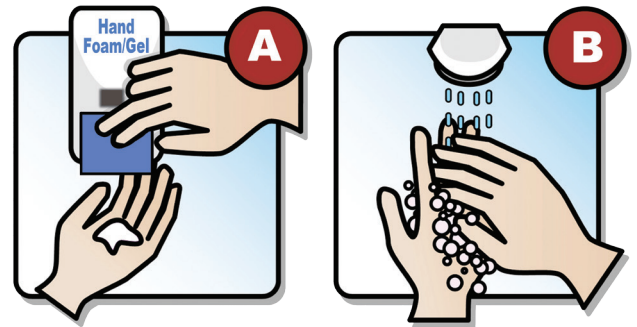

Clean hands with  
**A)** hand foam/gel or **B)** soap and water

**Staff:**

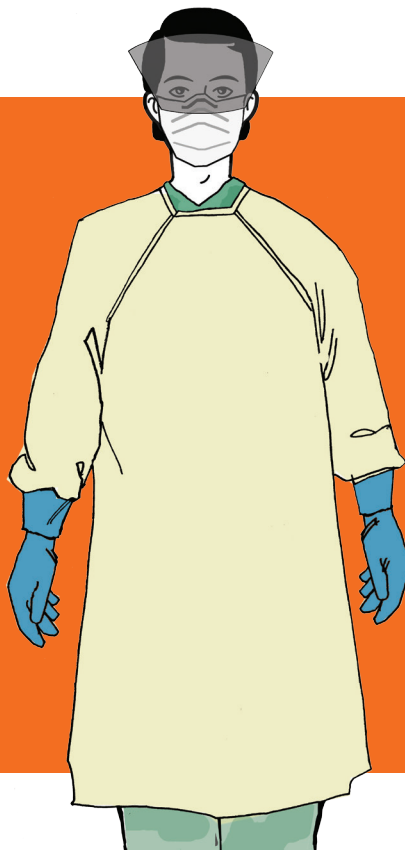

**Required:**

- **Point of Care Risk Assessment**
- **Gown & Gloves**
- **Procedure mask with eye protection**  
When within 2 metres of patient
- **Keep 2 metres between patients**

**KEEP  
SIGN POSTED  
UNTIL ROOM  
CLEANED**  
HOUSEKEEPER will  
remove sign after  
"Discharge"  
cleaning

# AIRBORNE PRECAUTIONS

**Private Room  
Negative Pressure**

**Keep door closed**

**Families  
and  
visitors:**



**Please report  
to staff before  
entering**

**Clean hands  
before entering and  
when leaving room**

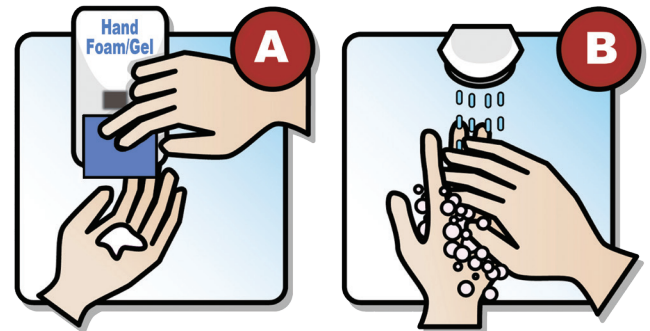

Clean hands with  
**A)** hand foam/gel or **B)** soap and water

**Staff:**



**KEEP  
SIGN POSTED  
UNTIL ROOM  
CLEANED**  
HOUSEKEEPER will  
remove sign after  
“Discharge”  
cleaning

**Required:**

- Point of Care Risk Assessment**
- N95 Respirator**



**Notify Infection Prevention & Control - Before Discontinuing Airborne Precautions**

# AIRBORNE & CONTACT PRECAUTIONS

**Private Room  
Negative Pressure**

**Keep door closed**

**Families  
and  
visitors:**



**Please report  
to staff before  
entering**

**Clean hands  
before entering and  
when leaving room**

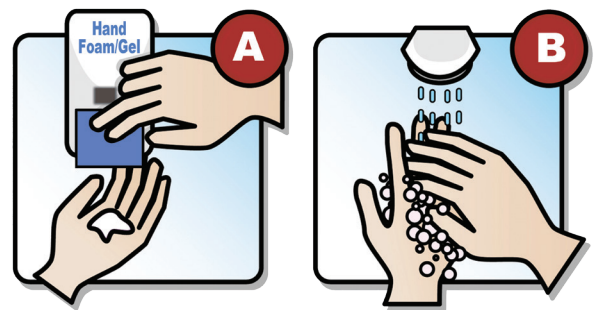

Clean hands with  
**A)** Hand foam/gel or **B)** soap and water

**Staff:**

**KEEP  
SIGN POSTED  
UNTIL ROOM  
CLEANED**  
HOUSEKEEPER will  
remove sign after  
"Discharge"  
cleaning

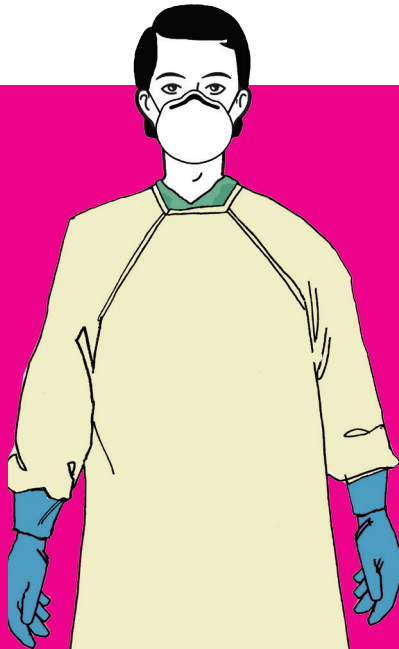

**Required:**

- **Point of Care Risk Assessment**
- **Gown and gloves**
- **N95 respirator**



**Notify Infection Prevention & Control - Before Discontinuing Airborne Precautions**



# Point of Care Risk Assessment

| Risk   | Protection   |
|--|--|
| • Contact with patient or environment expected   | • Hand hygiene   |
| • Splash or spray of blood or body fluids/secretions anticipated   | • Mask and eye protection<br>• Put on gown if soiling of clothing is likely  |
| • Contact with mucous membranes<br>• Non-intact skin, blood, body fluids, secretions, excretions or soiled or likely soiled item/surface anticipated | • Perform hand hygiene, then don gloves<br>• Perform hand hygiene after PPE removal and before leaving patient environment |

|   | Contact   | Contact Plus             | Droplet  | Droplet + Contact  | Airborne                                       | Airborne+ Contact                                  |
|---|---|--------------------------|--|--|--|--|
| <b>Organism-based precautions</b><br>(examples only; not complete list) | CPO, MRSA, VRE, lice, scabies   | <i>C. difficile</i>      | <i>N. meningitidis</i> , mumps, pertussis      | Influenza, invasive group A <i>Streptococcus</i>               | Tuberculosis (TB), measles                     | Varicella (chickenpox, disseminated herpes zoster) |
| <b>Syndromic precautions</b>  | Draining wound, diarrhea, infestation   | Diarrhea and/or vomiting | Stiff neck + fever + headache                  | Malaise + acute cough + fever, toxic shock                     | Fever + weight loss + cough + high risk for TB | Disseminated rash + fever                          |
| <b>Private room</b>   | Preferred. For suspect & confirmed CPO: yes   | Preferred                | Preferred. If in multi-bed room, draw curtain. | Preferred. If in multi-bed room, draw curtain.                 | Yes  | Yes  |
| <b>Negative pressure room</b>   | No  | No                       | No   | No   | Yes  | Yes  |
| <b>Staff PPE</b>  | Gown + gloves   | Gown + gloves            | Procedure mask and eye protection              | Procedure mask + eye protection + gown + gloves                | N95 respirator                                 | N95 respirator + gown + gloves                     |
| <b>Visitor PPE</b>  | Gown + gloves if direct care  | Gown + gloves            | Procedure mask and eye protection              | Procedure mask + eye protection (+gown +gloves if direct care) | Offer N95 respirator to visitor                | N95 respirator (+gown +gloves if direct care)      |
| <b>Parents of pediatric patients</b>                                    | Clean hands before entering and on leaving room.<br>Do not go into common areas such as patient kitchens, playrooms, school rooms, patient lounges. |                          |  |  |  |  |
| <b>Patient wears a procedure mask during transport</b>                  | No  | No                       | Yes  | Yes  | Yes  | Yes  |